



Palmerston North Cemeteries & Crematorium

Kelvin Grove, Terrace End, Ashhurst, Bunnythorpe
Places to farewell & commemorate loved ones

Remember

Palmerston North City Council provides four cemeteries and one crematorium for the people of the city and the region.

Kelvin Grove Cemetery, the main city cemetery, is situated within 22ha of park-like surroundings on the outskirts of the city. Kelvin Grove provides cremation and burial services to residents of Palmerston North and surrounding districts. The first burials at Kelvin Grove Cemetery took place in 1927.

The historic **Terrace End Cemetery** was the first permanent burial ground in the city, established in 1875. **Ashhurst** and **Bunnythorpe cemeteries** provide a final resting place for residents of those villages.

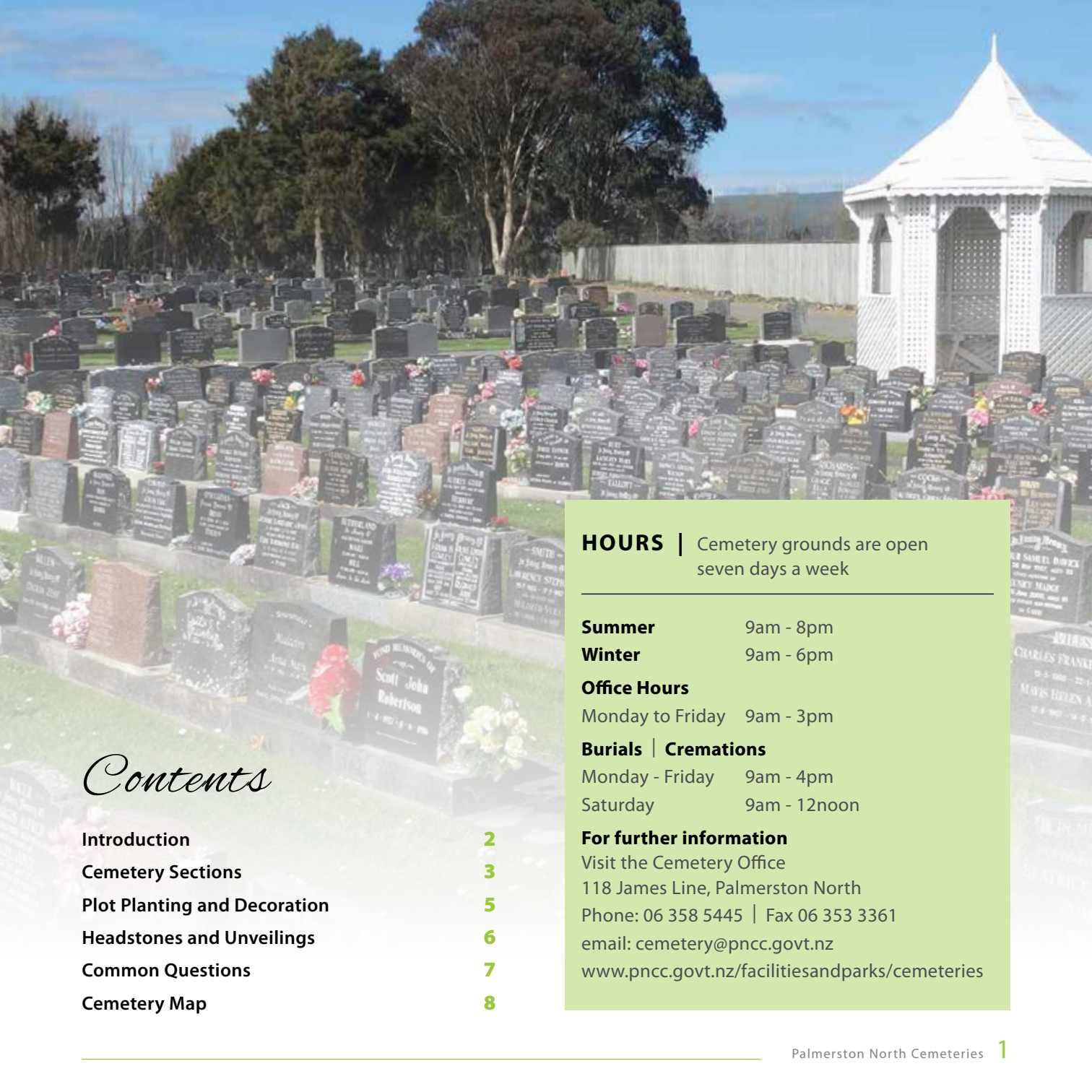

Contents

- Introduction **2**
- Cemetery Sections **3**
- Plot Planting and Decoration **5**
- Headstones and Unveilings **6**
- Common Questions **7**
- Cemetery Map **8**

HOURS | Cemetery grounds are open seven days a week

Summer 9am - 8pm

Winter 9am - 6pm

Office Hours

Monday to Friday 9am - 3pm

Burials | Cremations

Monday - Friday 9am - 4pm

Saturday 9am - 12noon

For further information

Visit the Cemetery Office

118 James Line, Palmerston North

Phone: 06 358 5445 | Fax 06 353 3361

email: cemetery@pncc.govt.nz

www.pncc.govt.nz/facilitiesandparks/cemeteries



Terrace End Cemetery

Introduction

Kelvin Grove Cemetery and Crematorium is situated at 118 James Line, off Napier Rd, on the outskirts of Palmerston North. The Council also administers the Terrace End, Ashhurst, and Bunnythorpe cemeteries.

The historic **Terrace End Cemetery** on Napier Rd, established in 1872, is the city's original burial ground. Limited burials in family plots still take place at Terrace End Cemetery.

Burials are available at **Ashhurst** and **Bunnythorpe** cemeteries for residents of those communities.

It is the policy of Palmerston North City Council (PNCC) to recover a portion of the operating costs of the cemeteries from the users. Fees apply for all services provided including: purchase of right of interment in a plot, burial of a body or ashes, cremation, memorial permits, database searches, etc.

A full schedule of fees can be found on the PNCC website at www.pncc.govt.nz. (Search "Cemetery fees").

Individuals can carry out a search of the PNCC Cemetery and Cremation database from a link on the PNCC website. Note: the database is not a comprehensive list of all deaths in Palmerston North.

All rights of burial in Palmerston North Cemeteries are currently granted "in perpetuity". Rules and regulations governing burial, cremation and other activities within the cemetery are covered by the Burial and Cremation Act and Palmerston North Cemeteries and Crematorium Bylaw.

After reading this booklet, if you have any further questions or want to talk about your specific requirements, please talk to your Funeral Director or the cemetery staff.

Crematorium and Chapel

The Palmerston North Crematorium, set in attractive surroundings at Kelvin Grove Cemetery, is equipped with a modern, clean-burning gas fired cremator.

The Crematorium Chapel is available for hire as a place where families can hold a memorial service to farewell their loved ones.

Full services or short committal ceremonies can be scheduled on Monday to Friday 9am - 4pm, or on Saturday from 9am - 12noon.

The large chapel comfortably seats 120 people and is fully equipped with audio visual equipment, an organ, and a webcam for live streaming services.

The chapel can be booked to hold services for burials as well as cremations.

Please make all bookings for the use of the chapel through your funeral director or discuss your requirements with our staff. Modest fees apply.

Cremation

Cremation is the end of life choice for 70-80% of families. Your funeral director can help with the paperwork required for a cremation.



Kelvin Grove Cemetery Sections

There are different areas within the Kelvin Grove Cemetery which gives families a variety of ways to remember their loved ones.

Different areas have specific rules around what can or cannot be done on the site. The rules are outlined in the PNCC Cemeteries and Crematorium Bylaw.

Full Burial options

Heritage Areas

The older parts of Kelvin Grove Cemetery where full grave covering was the norm. Opened in 1927, this area is now only available for ash interments and burials in family plots.

Sections A, B, C, E, F, G, H, I.

Services Section

An area of lawn cemetery set aside for eligible military service personnel and their spouses or partners. Regulations for interment in the Services Section are set down by Veterans Affairs NZ.

Sections D, DA, DB.



General Lawn

Contains non-denominational lawn burial plots. These can be utilised for interment of adults, children or for ash interment. Plots can be used for burial of two bodies provided this is advised to staff at the time of the first interment.

Additional ash urns can also be buried in lawn cemetery plots. Families may decorate graves of lawn plots for up to five years (conditions apply, refer to page 9).

Sections J, L, M, P, Q, R, S, U, V.



Children's Lawn

This section of the cemetery is set aside for burial of children up to the age of 13. Families may decorate grave sites in this area providing they take responsibility for the maintenance and care of the site.

An ash berm is also available in this area.
Section O.



Denominational Areas

The Jewish and Muslim communities have separate areas of the lawn cemetery set aside for burial of people from these faiths. People wishing to utilise these areas should advise their funeral director or cemetery staff.

In earlier times various Christian faiths were allocated specific areas. Areas for Catholic, Anglican, Presbyterian, Wesleyan and other faiths exist but burials or ash interment can only occur in reserved plots within these sections.

Muslim Sections P9, U17, 18, 19.

Jewish Section P15.



Ash Burial options



Services Section

Ash burial option is available for eligible service men and women within the Services Section of the cemetery.



Memorial Gardens (Section T)

Standard headstones with the ash urn interred in the grass berm in front of the memorial.



Memorial Beams (Sections U2A, VA)

Ash beams alongside regular full burial plots. The ash urn is interred in the grass berm in front of the memorial.



Memorial Granite Plaques (Sections U/1A)

A small concrete base with a granite plaque affixed to the reclining face. The ash urn is interred in the grass berm in front of the memorial.



Niche Wall

(Section GK 4)

Niches within a memorial wall are provided where up to two ash urns can be secured behind a memorial plaque.



Remembrance Garden Kerb

(Section GK 3)

A raised garden area where ash burial has been permitted in the garden behind a memorial brass plaque mounted on the kerb.

Scattering of Ashes

Ashes can be scattered in appropriate places at Palmerston North's cemeteries eg. in gardens, under trees, along shelter belts. In the true spirit of returning the ashes to the earth, there is no certainty that the ashes will remain undisturbed forever.

Cemetery staff can advise about scattering of ashes in the cemetery.



Memorial Granite Plaques

Other Memorial options

Remembrance Garden Kerb Plaques ▶ (Section GK 4)

Raised gardens arranged in a wagon-wheel layout. A granite, permanite or brass memorial plaque is mounted on the kerb in front of the garden.

Ash burial and placement of ornaments or plants is not permitted in this area.

Book of Remembrance

A Book of Remembrance is kept on display at the Crematorium. On request families can have their loved one's name handwritten in beautiful script on the page of the day of their death as a distinguished and lasting memorial.

Pages are turned daily so entries are displayed on the anniversary of the date of death. The room is open for viewing during normal cemetery open hours.

For viewing other days, contact cemetery staff. ▼



Sands Memorial Area (Section K) ▲

A Sands (Pregnancy, baby and infant loss support) area is provided at Kelvin Grove Cemetery. Memorial plaques commemorating these much wanted and loved souls can be installed within the Sands Memorial Garden.

For more information contact Sands on 027 590 3444 or sandsmana.horo@gmail.com



Plot plantings & decorations

Kelvin Grove Cemetery is a Lawn Cemetery. The final state of the burial areas will be grassed berms in front of the headstone beam. However, Council recognises that some families wish to remember their loved ones in special ways, especially in the early years following a death.

Accordingly PNCC allows families who choose to decorate graves with annual plantings or small unbreakable ornamentation can do so, with conditions, for up to 5 years from the date of burial. Families choosing to decorate the berm of the grave must maintain the site in a tidy condition and apply annually for permission to retain the grave decorations. (PNCC Cemetery Bylaw Clause 14)

After 5 years all berm decorations must be removed

and the berm will be returned to lawn. Flowers and other unbreakable ornaments can be placed on the headstone base and memorial beam provided the mowing strip in front of the headstone is kept clear.

Fragile, dangerous or inappropriate objects on graves will be removed by Council staff.

Families with children buried in the Children's Section can decorate the grave site but must care for the decorations. Derelict or neglected sites will be cleared and returned to grass.

Restricted ornamentation is allowed in some Memorial Garden Kerb areas (GK3) but not in others (GK1, GK2, GK4). The gardens will be maintained by Council.



*Maintenance of headstones is the responsibility of the family.
Contact a Monumental Mason for assistance.*

Headstones & Unveilings

A headstone or memorial plaque can be erected at any time following burial. A Funeral Director, Monumental Mason or the family must apply for a permit to erect a headstone using the Memorial Application Form available from PNCC, and pay the applicable fees.

Materials and dimensions of headstones and plaques are regulated by a set of specifications which form part of the PNCC Cemeteries and Crematorium Bylaw. Specifications are outlined in the Memorial Application form. Granite is the most commonly used material for headstones although other rock can be used if approved. Evidence of durability must be provided. Granite is available in a variety of colours and has excellent durability. Some ash burial areas allow for granite, permanite or bronze plaques as memorials.

In the general lawn cemetery area headstones can be up to 1000mm high (including the base). In the children's and ash burial areas headstones can be up to 500mm high (including the base). For more information on headstone regulations and dimensions, contact a Monumental Mason or Funeral Director.

Unveiling ceremonies can be held at PNCC cemeteries. The family or person conducting the unveiling should book a time with the cemetery staff to avoid conflict with other activities. As a rule, Saturday afternoons or Sundays are the best times as burials will not normally be scheduled at these times. If ashes are to be buried at the same time as the unveiling, cemetery staff must be advised as their assistance will be required for site preparation.



Tracing your ancestors

If you are tracing your ancestors you can check the cemetery records online at: www.pncc.govt.nz/ - Click on "Cemetery and cremation search".

Not all people who have died in Palmerston North will appear on the PNCC database.

Some people will be buried elsewhere in the country and any private cremations will not be recorded in the PNCC records.

Common questions

What fees do I need to pay?

PNCC provides a range of services at its cemeteries for which fees are charged. The services are subsidised by up to 40% by ratepayers. The current fees for different services can be found on the PNCC website at www.pncc.govt.nz. Fees are reviewed annually. PNCC fees will be included on the invoice for the burial or cremation that you receive from your Funeral Director.

What am I paying for?

Your burial fees cover the “right of interment” of the body or ashes in perpetuity. The family does not “own” the plot. There are separate fees for the “right of interment” and for the grave digging.

When I have decided between burial and cremation, how do I proceed?

Your Funeral Director will be able to advise the family about costs and the appropriate procedures and requirements for burial or cremation at any of Palmerston North cemeteries.

Can we choose the burial plot for our loved one?

In any cemetery an orderly method of land use is important. Therefore only a limited choice of plot is possible. Cemetery staff can advise the next 5 or 6 plots scheduled to be used and families can select from these.

What can we do with my loved ones ashes?

PNCC provides a number of ash burial options, all with a similar cost, apart from interment in the niche wall. Refer to pages 6-7 for details.

Staff will prepare the ash burial site for the interment of ashes.

Ashes can also be scattered in the environment provided it is done sensitively and with the permission of the landowner. In these cases families may wish to place a memorial plaque in the cemetery as a lasting memory of their loved one. Refer to Section GK4 page 8.



Common questions continued

Can my parent's ashes be buried in a plot with their parents?

Yes, provided the consent of the plot holder is obtained. If the plot holder is dead, consent of their family is required. This can usually be arranged by your Funeral Director.

Where can I find my relatives grave site?

You can find the Section, Block and Plot Number of your relative's grave via a search of the PNCC online Cemetery and Cremation database. Using this information you can then find the location of the Section and Block by referring to the map on the outside wall of the cemetery office or overleaf. All rows (Blocks) are marked with a plaque at one end showing the Section and Block number and the direction the plots run.

I cannot find my relative's name in the City Council records. Why?

Your relative may not have been cremated in the PNCC cremator or may have been buried in a cemetery elsewhere in New Zealand.



Do I need a permit to install a headstone?

Yes. A permit is issued by PNCC and a small fee applies. Applications for headstone or memorial plaque permits are submitted on a Memorial Application form and must contain details of the headstone dimensions and wording. The wording must be acceptable to Council ie. wording or images which may be considered offensive or inappropriate will not be approved. A Monumental Mason or cemetery staff can assist.

The lettering on my grandparents' headstone is faded and partly covered in moss!

It is the responsibility of the family, not Council, to maintain the headstone. Regular cleaning is recommended. In time, the paint in the lettering will fade and will need renewing. For assistance contact a Monumental Mason.

Why are grave decorations allowed in the Palmerston North lawn cemetery, but not in other places?

In response to some family's wishes to adorn their loved ones grave sites Council has allowed families to decorate the full grave site for a maximum of 5 years. The site must be kept in tidy condition. Refer to Page 9.

Our grave site has sunk. What can we do about this?

Clay soils will always settle after backfilling. Staff regularly top up unadorned graves but if this is missed, please advise the cemetery office and they will attend to your request.

Cemetery maps



Kelvin Grove Cemetery



Terrace End Cemetery | Napier Road

Cemetery maps



Ashhurst Cemetery
| Ashhurst Domain

Bunnythorpe Cemetery
| Maple Street

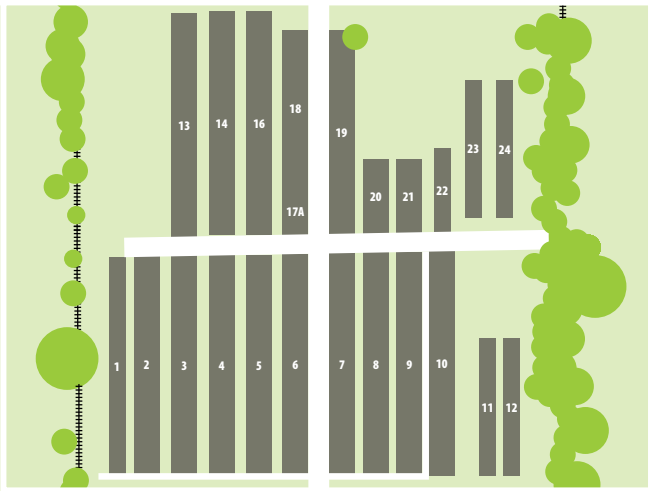

Directory of Funeral Directors and Monumental Masons

If you have any questions after reading this booklet the the cemetery staff, your funeral director or a monumental mason will be able to help you.

ROSE CITY FUNERALS 

06 354 8888

Corner Ruahine & Grey Streets, Palmerston North 4414
 info@rosecityfunerals.co.nz
 www.rosecityfunerals.co.nz

TRUSTED BY GENERATIONS FOR FUNERALS & HEADSTONES

Beauchamps FUNERAL HOME & CHAPEL

A Traditional family firm, with a modern professional approach.
 Where nothing is too much trouble.

P.NORTH, FEILDING AND MARTON
 (06) 355 1889 | admin@beauchamp.co.nz

Celebrating a life lived with complete funeral packages to honour your loved one

THE Lychway
 FUNERAL DIRECTORS

walking with you every step of the way

06 357 8143 Palmerston North www.thelychway.co.nz
 FORMERLY THOMAS GRIGGS & SON



Kelvin Grove Cemetery Chapel

Fully equipped chapel available for funeral and committal services

KELVIN GROVE CEMETERY | 06 356 8199

Beauchamp Signs & Memorials

MANAWATU'S LEADING MONUMENTAL MASONS

Premium headstones, memorial plaques and monumental masonry that will stand the test of time

DEAL DIRECT WITH THE TRADESMAN

www.bsm.co.nz - 06 323 2308
 bsm@beauchamp.co.nz

 **ANDERSON MEMORIALS LTD**

Manawatu & Districts Headstone Shop

Memorials installed in all cemeteries by our own qualified master tradesmen

5 Generations of Experience

New Memorials • Custom Designs Made To Order
 Memorial Renovations • Additional Inscriptions
 Cleaning • Professional Advice • Indoor Showrooms

NZMMA Registered for your assurance

PALMERSTON NORTH: 707 Main Street Ph/Fax 356 4782
 FEILDING: 158 Kimbolton Road Ph/Fax 323 6616
 Email: anderson.memorials@extra.co.nz www.anderson-memorials.co.nz



Palmerston North City Council

W pncc.govt.nz | E info@pncc.govt.nz | P 356 8199 | Private Bag 11034, The Square, Palmerston North, 4442